



**Surrey Heath Borough Council**  
Surrey Heath House  
Knoll Road  
Camberley  
Surrey GU15 3HD  
Telephone: (01276) 707100  
Facsimile: (01276) 707177  
DX: 32722 Camberley  
Web Site: [www.surreyheath.gov.uk](http://www.surreyheath.gov.uk)

**Division:** Transformation  
**Please ask for:** Rachel Whillis  
**Direct Tel:** 01276 707319  
**E-Mail:** [democratic.services@surreyheath.gov.uk](mailto:democratic.services@surreyheath.gov.uk)

Wednesday, 10 December 2014

To: The Members of the **Licensing SUB COMMITTEE**  
(Councillors: Bill Chapman, Beverley Harding, Paul Ilnicki (Substitute) and Valerie White)

Dear Councillor,

A meeting of the **Licensing SUB COMMITTEE** will be held at Council Chamber, Surrey Heath House on Thursday, 18 December 2014 at 10.00 am. The agenda will be set out as below.

Please note that this meeting will be recorded.

Yours sincerely

Karen Whelan

Chief Executive

---

## AGENDA

Pages

### Part 1 (Public)

- 1 Election of Chairman**
- 2 Declarations of Interest**

Members are invited to declare that they do not have a Disclosable Pecuniary Interest or non-pecuniary interest. Members who have a Disclosable Pecuniary interest in the application will not be able to take part in its consideration and would be advised not to participate if they have a non-pecuniary interest. Members who consider they may have an interest MUST consult the Monitoring Officer or the Democratic Services Officer prior to the meeting as the meeting cannot proceed without all members being present.

- 3 Licensing Act 2003**

Following objections received, to consider an application for a premises licence for **126 Frimley Road, Camberley, Surrey.**

<b>a</b>	<b>Licensing Officer's Report</b>	<b>1 - 4</b>
<b>b</b>	<b>Document One - Application for a Premises License</b>	<b>5 - 28</b>
<b>c</b>	<b>Document Two - Representations</b>	<b>29 - 36</b>

**Report to** Licensing Sub-Committee  
**Date of meeting** Date December 2014  
**Author** Derek Seekings, Licensing Officer



**DECISION REQUIRED**  
Not exempt

**Report Title:** Application for a Premises Licence at 126, Frimley Road, Camberley, Surrey, GU15 2QN submitted by Grover Convenience Store Ltd.

## **SUMMARY**

The report presents the application for a new Premises Licence relating to 126 Frimley Road, Camberley, Surrey, GU15 2QN. The Licensing authority is required to hold a hearing to determine this premises licence application because relevant representations have been received.

The purpose of the hearing is for the Licensing Sub-Committee to consider the Application, in relation to the Licensing Act 2003's Licensing Objectives. The Licensing objectives being in this Application:

- 1 The prevention of crime and disorder
- 2 Public safety
- 3 The prevention of public nuisance
- 4 The protection of children from harm

Copies of the application, relevant representations and other correspondence received to date are attached to this report.

## **RECOMMENDATIONS**

The Sub-Committee is recommended:

- i) To determine the premises licence application.

## **REASONS FOR RECOMMENDATIONS**

- i) The Sub Committee is required to make a decision under the Licensing Act 2003

## **BACKGROUND INFORMATION**

### **1 INTRODUCTION**

**The purpose of this report**

- 1.1 For the Sub-Committee to determine the application for a Premises Licence in respect of 126 Frimley Road, Camberley, Surrey, GU15 2QN.

The application is submitted under Section 17 and determined under Section 18 of the Licensing Act 2003.

1.2 **Background of the premises**

**Statutory background**

- 1.3 The Licensing Act 2003 and secondary legislation in the form of Regulations there under.

**Relevant Government policy**

- 1.4 Guidance issued under section 182 of the Licensing Act 2003. (effective from October 2014)

**Relevant Council policy**

- 1.5 Statement of Licensing Policy.

2. **DETAILS**

2.1 **Application**

The application is made by Mr Manmeet Grover on behalf of Grover Convenience Store Limited of 4 Woodlands Parade, Feltham Hill Road, Ashford, Middlesex TW15 1QD and relates to 126 Frimley Road, Camberley, Surrey GU15 2QN.

A Copy of the application is included and attached at Document 1.

The application is for the supply of alcohol for consumption off the premises only, and from 0600 to 2300hrs daily.

The provision of regulated entertainment and late night refreshment are not included in the application.

2.2 **Grounds for the Hearing**

'Other Persons' contend that the carrying on of licensable activities at the premises could lead to the following licensing objectives being seriously undermined:

- i) The prevention of crime and disorder;
- ii) Protection of public safety;
- iii) Prevention of public nuisance;
- iv) Protection of children from harm;

**Further evidence submitted regarding the Application**

- 2.3 Details included in documents attached to this report.

**Responsible Authority Representations/ Comments**

- 2.4 Details of Responsible Authority representations received:

**2.4.1 Police**

No representations.

**2.4.2 Fire**

No representations.

**2.4.3 Local Planning Authority**

No representations.

**2.4.4 Environmental Health**

No representations.

**2.4.5 Child Protection Agency**

No representations.

**2.4.6 Licensing Authority**

The application was submitted on 3 November 2014. The application was completed correctly and advertised as required by the Licensing Act 2003.

**2.4.7 Health and Safety Executive**

No representations.

**Any Other Person - Representations**

2.5 Details of 'any other person'. A total of five have been received from 'other persons'.

A Copy of the representations are also included and attached at Document 2. The representations are relevant and relate to all four of the licensing objectives.

**2.6 Policy Considerations**

Details of relevant policy considerations, including local policy statement:

Paragraphs 1 – 89, 95 – 138 of the Council's Licensing Policy Statement are applicable to the consideration of this application.

Paragraphs 48 – 52 make particular reference to premises where alcohol is supplied for consumption off the premises.

**3. NEXT STEPS**

The Sub-Committee is obliged to determine this application with a view to promoting the Licensing Objectives.

In making its decision, the Sub-Committee is also required to have regard to Guidance issued under Section 182 Licensing Act 2003, as amended, and the Council's own Licensing Policy.

The Sub-Committee must have regard to all the representations made and the evidence it hears.

The Sub-Committee must take such of the following steps as it considers necessary for the promotion of the Licensing Objectives:

- To grant the licence subject to conditions
- To exclude a licensable activity or amend timings to which the application relates
- To reject the application

The Sub-Committee is asked to note that it may not add conditions or reject the whole or part of the application merely because it considers it desirable to do so. It must actually be appropriate in order to promote the licensing objectives.

**4. HOW THE PROPOSED COURSE OF ACTION WILL PROMOTE HUMAN RIGHTS AND EQUALITY**

Human Rights and Equality issues will be taken into account on the determination of the Application by balancing the competing rights of the applicant, responsible authorities and 'other persons'.

**Attachments:**

Document 1: Application for a Premises Licence

Document 2: Representations from 'any other persons'

**Application for a premises licence to be granted  
under the Licensing Act 2003**

**PLEASE READ THE FOLLOWING INSTRUCTIONS FIRST**

Before completing this form please read the guidance notes at the end of the form.  
If you are completing this form by hand please write legibly in block capitals. In all cases ensure that your answers are inside the boxes and written in black ink. Use additional sheets if necessary.

You may wish to keep a copy of the completed form for your records.

**I/We Mr Manmeet Grover / Grover Convenience Store Limited**

*(Insert name(s) of applicant)*

**apply for a premises licence under section 17 of the Licensing Act 2003 for the premises described in Part 1 below (the premises) and I/we are making this application to you as the relevant licensing authority in accordance with section 12 of the Licensing Act 2003**

**Part 1 – Premises Details**

Postal address of premises or, if none, ordnance survey map reference or description						
126 Frimley Rd		<table border="1"> <tr> <td>SURREY HEATH BOROUGH COUNCIL</td> </tr> <tr> <td align="center">- 3 NOV 2014</td> </tr> <tr> <td>COMMUNITY SERVICES - LICENSING</td> </tr> </table>		SURREY HEATH BOROUGH COUNCIL	- 3 NOV 2014	COMMUNITY SERVICES - LICENSING
SURREY HEATH BOROUGH COUNCIL						
- 3 NOV 2014						
COMMUNITY SERVICES - LICENSING						
Post town	Camberley	Post code	GU15 2QN			
Telephone number at premises (if any)	07773026320 / 01784 255 220					
Non-domestic rateable value of premises	£ 14,500 Band B					

**Part 2 - Applicant Details**

Please state whether you are applying for a premises licence as  
Please tick yes

- a) an individual or individuals \*  please complete section (A)
- b) a person other than an individual \*
  - i. as a limited company  please complete section (B)
  - ii. as a partnership  please complete section (B)
  - iii. as an unincorporated association or  please complete section (B)
  - iv. other (for example a statutory corporation)  please complete section (B)
- c) a recognised club  please complete section (B)
- d) a charity  please complete section (B)

- e) the proprietor of an educational establishment  please complete section (B)
- f) a health service body  please complete section (B)
- g) a person who is registered under Part 2 of the Care Standards Act 2000 (c14) in respect of an independent hospital  please complete section (B)
- h) the chief officer of police of a police force in England and Wales  please complete section (B)

\* If you are applying as a person described in (a) or (b) please confirm:

Please tick yes

- I am carrying on or proposing to carry on a business which involves the use of the premises for licensable activities; or
- I am making the application pursuant to a
  - statutory function or
  - a function discharged by virtue of Her Majesty's prerogative

**(A) INDIVIDUAL APPLICANTS** (fill in as applicable)

<b>Mr</b> <input type="checkbox"/>	<b>Mrs</b> <input type="checkbox"/>	<b>Miss</b> <input type="checkbox"/>	<b>Ms</b> <input type="checkbox"/>	<b>Other Title</b> (for example, Rev)	□□□□□
<b>Surname</b> □□□□□			<b>First names</b> □□□□□		
<b>I am 18 years old or over</b>				<input type="checkbox"/>	<b>Please tick yes</b>
<b>Current postal address if different from premises address</b>		□□□□□			
<b>Post Town</b>	□□□□□			<b>Postcode</b>	□□□□□
<b>Daytime contact telephone number</b>		□□□□□			
<b>E-mail address (optional)</b>	□□□□□				



**SECOND INDIVIDUAL APPLICANT (if applicable)**

Mr <input type="checkbox"/>	Mrs <input type="checkbox"/>	Miss <input type="checkbox"/>	Ms <input type="checkbox"/>	Other Title (for example, Rev)	□□□□□
Surname □□□□□			First names □□□□□		
I am 18 years old or over				<input type="checkbox"/> Please tick yes	
Current postal address if different from premises address		□□□□□			
Post Town	□□□□□	Postcode	□□□□□		
Daytime contact telephone number		□□□□□			
E-mail address (optional)	□□□□□				

**(B) OTHER APPLICANTS**

Please provide name and registered address of applicant in full. Where appropriate please give any registered number. In the case of a partnership or other joint venture (other than a body corporate), please give the name and address of each party concerned.

Name <b>GROVER CONVENIENCE STORE LIMITED</b>
Address <b>4 WOODLANDS PARADE FELTHAM HILL ROAD ASHFORD MIDDLESEX UNITED KINGDOM TW15 1QD</b>
Registered number (where applicable) <b>Company No. 07601397</b>
Description of applicant (for example, partnership, company, unincorporated association etc.) <b>Limited Company</b>
Telephone number (if any) <b>Business Mob :07773026320 – Business Landline: 01784 255220</b>
E-mail address (optional) <b>Manmeet-grover@hotmail.co.uk</b>

**Part 3 Operating Schedule**

When do you want the premises licence to start?

Date Month Year  
**ASAP**

If you wish the licence to be valid only for a limited period, when do you want it to end?

Date Month Year  
**N/A**

Please give a general description of the premises (please read guidance note1)

**Premises will be selling Food and Non foods products aswell as Tobacco and Alcohol Beverages.**

**Small Convenience/General Grocery and Off Licence Store.**

**Spirits & Tobacco including high value products will be on display behind the counter out of customer reach.**

If 5,000 or more people are expected to attend the premises at any one time, please state the number expected to attend.

□ □ □ □ □
-----------

What licensable activities do you intend to carry on from the premises?

(Please see sections 1 and 14 of the Licensing Act 2003 and Schedules 1 and 2 to the Licensing Act 2003)

**Provision of regulated entertainment**

**Please tick yes**

- |   |                          |
|---|--------------------------|
| a) plays (if ticking yes, fill in box A)  | <input type="checkbox"/> |
| b) films (if ticking yes, fill in box B)  | <input type="checkbox"/> |
| c) indoor sporting events (if ticking yes, fill in box C)   | <input type="checkbox"/> |
| d) boxing or wrestling entertainment (if ticking yes, fill in box D)  | <input type="checkbox"/> |
| e) live music (if ticking yes, fill in box E)   | <input type="checkbox"/> |
| f) recorded music (if ticking yes, fill in box F)   | <input type="checkbox"/> |
| g) performances of dance (if ticking yes, fill in box G)  | <input type="checkbox"/> |
| h) anything of a similar description to that falling within (e), (f) or (g) (if ticking yes, fill in box H) | <input type="checkbox"/> |

**Provision of entertainment facilities:**

- i) making music (if ticking yes, fill in box I)
- j) dancing (if ticking yes, fill in box J)
- k) entertainment of a similar description to that falling within (i) or (j)  
(if ticking yes, fill in box K)

**Provision of late night refreshment** (if ticking yes, fill in box L)

**Supply of alcohol** (if ticking yes, fill in box M)

**In all cases complete boxes N, O and P**

**A**

Plays Standard days and timings (please read guidance note 6)			Will the performance of a play take place indoors or outdoors or both – please tick (please read guidance note 2)	Indoors	<input type="checkbox"/>		
Day	Start	Finish		Outdoors	<input type="checkbox"/>		
Mon	□□□□ □	□□□□ □	<b>Please give further details here</b> (please read guidance note 3) □□□□□	Both	<input type="checkbox"/>		
	□□□□ □	□□□□ □					
Tue	□□□□ □	□□□□ □					
	□□□□ □	□□□□ □					
Wed	□□□□ □	□□□□ □		<b>State any seasonal variations for performing plays</b> (please read guidance note 4) □□□□□			
	□□□□ □	□□□□ □					
Thur	□□□□ □	□□□□ □					
	□□□□ □	□□□□ □					
Fri	□□□□ □	□□□□ □			<b>Non standard timings. Where you intend to use the premises for the performance of plays at different times to those listed in the column on the left, please list</b> (please read guidance note 5) □□□□□		
	□□□□ □	□□□□ □					
Sat	□□□□ □	□□□□ □					
	□□□□ □	□□□□ □					
Sun	□□□□ □	□□□□ □					
	□□□□ □	□□□□ □					

**B**

Films Standard days and timings (please read guidance note 6)			Will the exhibition of films take place indoors or outdoors or both – please tick (please read guidance note 2)	Indoors	<input type="checkbox"/>		
Day	Start	Finish		Outdoors	<input type="checkbox"/>		
				Both	<input type="checkbox"/>		
Mon	□□□□ □	□□□□ □	<b>Please give further details here</b> (please read guidance note 3) □□□□□				
	□□□□ □	□□□□ □					
Tue	□□□□ □	□□□□ □					
	□□□□ □	□□□□ □					
Wed	□□□□ □	□□□□ □		<b>State any seasonal variations for the exhibition of films</b> (please read guidance note 4) □□□□□			
	□□□□ □	□□□□ □					
Thur	□□□□ □	□□□□ □					
	□□□□ □	□□□□ □					
Fri	□□□□ □	□□□□ □			<b>Non standard timings. Where you intend to use the premises for the exhibition of films at different times to those listed in the column on the left, please list</b> (please read guidance note 5) □□□□□		
	□□□□ □	□□□□ □					
Sat	□□□□ □	□□□□ □					
	□□□□ □	□□□□ □					
Sun	□□□□ □	□□□□ □					
	□□□□ □	□□□□ □					

**C**

<b>Indoor sporting events</b> Standard days and timings (please read guidance note 6)			<b>Please give further details</b> (please read guidance note 3) □□□□□
Day	Start	Finish	<b>State any seasonal variations for indoor sporting events</b> (please read guidance note 4) □□□□□
Mon	□□□□ □	□□□□ □	
	□□□□ □	□□□□ □	
Tue	□□□□ □	□□□□ □	
	□□□□ □	□□□□ □	
Wed	□□□□ □	□□□□ □	
	□□□□ □	□□□□ □	
Thur	□□□□ □	□□□□ □	
	□□□□ □	□□□□ □	
Fri	□□□□ □	□□□□ □	
	□□□□ □	□□□□ □	
Sat	□□□□ □	□□□□ □	
	□□□□ □	□□□□ □	
Sun	□□□□ □	□□□□ □	
	□□□□ □	□□□□ □	
<b>Non standard timings. Where you intend to use the premises for indoor sporting events at different times to those listed in the column on the left, please list</b> (please read guidance note 5) □□□□□			

**D**

<b>Boxing or wrestling entertainments</b> Standard days and timings (please read guidance note 6)			<b>Will the boxing or wrestling entertainment take place indoors or outdoors or both – please tick</b> (please read guidance note 2)	Indoors	<input type="checkbox"/>					
Day	Start	Finish		Outdoors	<input type="checkbox"/>					
Mon	□□□□ □	□□□□ □	<b>Please give further details here</b> (please read guidance note 3) □□□□□	Both	<input type="checkbox"/>					
	□□□□ □	□□□□ □								
Tue	□□□□ □	□□□□ □		<b>State any seasonal variations for boxing or wrestling entertainment</b> (please read guidance note 4) □□□□□						
	□□□□ □	□□□□ □								
Wed	□□□□ □	□□□□ □			<b>Non standard timings. Where you intend to use the premises for boxing or wrestling entertainment at different times to those listed in the column on the left, please list</b> (please read guidance note 5) □□□□□					
	□□□□ □	□□□□ □								
Thur	□□□□ □	□□□□ □								
	□□□□ □	□□□□ □								
Fri	□□□□ □	□□□□ □								
	□□□□ □	□□□□ □								
Sat	□□□□ □	□□□□ □								
	□□□□ □	□□□□ □								
Sun	□□□□ □	□□□□ □								
	□□□□ □	□□□□ □								

**E**

Live music Standard days and timings (please read guidance note 6)			Will the performance of live music take place indoors or outdoors or both – please tick (please read guidance note 2)	Indoors	<input type="checkbox"/>		
Day	Start	Finish		Outdoors	<input type="checkbox"/>		
				Both	<input type="checkbox"/>		
Mon	□□□□ □	□□□□ □	<b>Please give further details here</b> (please read guidance note 3) □□□□□				
	□□□□ □	□□□□ □					
Tue	□□□□ □	□□□□ □					
	□□□□ □	□□□□ □					
Wed	□□□□ □	□□□□ □		<b>State any seasonal variations for the performance of live music</b> (please read guidance note 4) □□□□□			
	□□□□ □	□□□□ □					
Thur	□□□□ □	□□□□ □					
	□□□□ □	□□□□ □					
Fri	□□□□ □	□□□□ □			<b>Non standard timings. Where you intend to use the premises for the performance of live music at different times to those listed in the column on the left, please list</b> (please read guidance note 5) □□□□□		
	□□□□ □	□□□□ □					
Sat	□□□□ □	□□□□ □					
	□□□□ □	□□□□ □					
Sun	□□□□ □	□□□□ □					
	□□□□ □	□□□□ □					



**F**

Recorded music Standard days and timings (please read guidance note 6)			Will the playing of recorded music take place indoors or outdoors or both – please tick (please read guidance note 2)	Indoors	<input type="checkbox"/>			
				Outdoors	<input type="checkbox"/>			
Day	Start	Finish	Both <input type="checkbox"/>					
Mon	□□□□ □	□□□□ □	<b>Please give further details here</b> (please read guidance note 3) □□□□□					
	□□□□ □	□□□□ □						
Tue	□□□□ □	□□□□ □						
	□□□□ □	□□□□ □						
Wed	□□□□ □	□□□□ □				<b>State any seasonal variations for the playing of recorded music</b> (please read guidance note 4) □□□□□		
	□□□□ □	□□□□ □						
Thur	□□□□ □	□□□□ □						
	□□□□ □	□□□□ □						
Fri	□□□□ □	□□□□ □	<b>Non standard timings. Where you intend to use the premises for the playing of recorded music at different times to those listed in the column on the left, please list</b> (please read guidance note 5) □□□□□					
	□□□□ □	□□□□ □						
Sat	□□□□ □	□□□□ □						
	□□□□ □	□□□□ □						
Sun	□□□□ □	□□□□ □						
	□□□□ □	□□□□ □						

**G**

Performances of dance Standard days and timings (please read guidance note 6)			Will the performance of dance take place indoors or outdoors or both – please tick (please read guidance note 2)	Indoors	<input type="checkbox"/>					
Day	Start	Finish		Outdoors	<input type="checkbox"/>					
Mon	□□□□ □	□□□□ □	<b>Please give further details here</b> (please read guidance note 3) □□□□□	Both	<input type="checkbox"/>					
	□□□□ □	□□□□ □								
Tue	□□□□ □	□□□□ □		<b>State any seasonal variations for the performance of dance</b> (please read guidance note 4) □□□□□						
	□□□□ □	□□□□ □								
Wed	□□□□ □	□□□□ □			<b>Non standard timings. Where you intend to use the premises for the performance of dance at different times to those listed in the column on the left, please list</b> (please read guidance note 5) □□□□□					
	□□□□ □	□□□□ □								
Thur	□□□□ □	□□□□ □								
	□□□□ □	□□□□ □								
Fri	□□□□ □	□□□□ □								
	□□□□ □	□□□□ □								
Sat	□□□□ □	□□□□ □								
	□□□□ □	□□□□ □								
Sun	□□□□ □	□□□□ □								
	□□□□ □	□□□□ □								

# H

<b>Anything of a similar description to that falling within (e), (f) or (g)</b> Standard days and timings (please read guidance note 6)			<b><u>Please give a description of the type of entertainment you will be providing</u></b> □□□□□		
Day	Start	Finish	<b><u>Will this entertainment take place indoors or outdoors or both – please tick</u></b> (please read guidance note 2)	Indoors	<input type="checkbox"/>
Mon	□□□□ □	□□□□ □		Outdoors	<input type="checkbox"/>
	□□□□ □	□□□□ □		Both	<input type="checkbox"/>
Tue	□□□□ □	□□□□ □	<b><u>Please give further details here</u></b> (please read guidance note 3) □□□□□		
Wed	□□□□ □	□□□□ □	<b><u>State any seasonal variations for entertainment of a similar description to that falling within (e), (f) or (g)</u></b> (please read guidance note 4) □□□□□		
	□□□□ □	□□□□ □			
Thur	□□□□ □	□□□□ □			
	□□□□ □	□□□□ □			
Fri	□□□□ □	□□□□ □			
	□□□□ □	□□□□ □			
Sat	□□□□ □	□□□□ □			
	□□□□ □	□□□□ □			
Sun	□□□□ □	□□□□ □			
	□□□□ □	□□□□ □			

<b>Provision of facilities for making music</b> Standard days and timings (please read guidance note 6)			<b>Please give a description of the facilities for making music you will be providing</b> □□□□□					
			<b>Will the facilities for making music be indoors or outdoors or both – please tick</b> (please read guidance note 2)		Indoors	<input type="checkbox"/>		
			Outdoors		<input type="checkbox"/>			
			Both		<input type="checkbox"/>			
Day	Start	Finish						
Mon	□□□□ □	□□□□ □	<b>Please give further details here</b> (please read guidance note 3) □□□□□					
	□□□□ □	□□□□ □						
Tue	□□□□ □	□□□□ □						
	□□□□ □	□□□□ □						
Wed	□□□□ □	□□□□ □						
	□□□□ □	□□□□ □						
Thur	□□□□ □	□□□□ □						
	□□□□ □	□□□□ □						
Fri	□□□□ □	□□□□ □				<b>Non standard timings. Where you intend to use the premises for provision of facilities for making music at different times to those listed in the column on the left, please list</b> (please read guidance note 5) □□□□□		
	□□□□ □	□□□□ □						
Sat	□□□□ □	□□□□ □						
	□□□□ □	□□□□ □						
Sun	□□□□ □	□□□□ □						
	□□□□ □	□□□□ □						

**J**

<b>Provision of facilities for dancing</b> Standard days and timings (please read guidance note 6)			<b>Will the facilities for dancing be indoors or outdoors or both – please tick</b> (see guidance note 2)	Indoors <input type="checkbox"/>				
				Outdoors <input type="checkbox"/>				
				Both <input type="checkbox"/>				
			<b>Please give a description of the facilities for dancing you will be providing</b> □□□□□					
Day	Start	Finish	<b>Please give further details here</b> (please read guidance note 3) □□□□□					
	Mon	□□□□ □				□□□□ □		
	□□□□ □	□□□□ □						
Tue	□□□□ □	□□□□ □						
	□□□□ □	□□□□ □						
Wed	□□□□ □	□□□□ □						
	□□□□ □	□□□□ □						
Thur	□□□□ □	□□□□ □						
	□□□□ □	□□□□ □						
Fri	□□□□ □	□□□□ □				<b>Non standard timings. Where you intend to use the premises for the provision of facilities for dancing entertainment at different times to those listed in the column on the left, please list</b> (please read guidance note 5) □□□□□		
	□□□□ □	□□□□ □						
Sat	□□□□ □	□□□□ □						
	□□□□ □	□□□□ □						
Sun	□□□□ □	□□□□ □						
	□□□□ □	□□□□ □						

**K**

<b>Provision of facilities for entertainment of a similar description to that falling within i or j</b> Standard days and timings (please read guidance note 6)			<b><u>Please give a description of the type of entertainment facility you will be providing</u></b> □□□□□		
Day	Start	Finish	<b><u>Will the entertainment facility be indoors or outdoors or both – please tick</u></b> (please read guidance note 2)	Indoors	<input type="checkbox"/>
Mon	□□□□ □	□□□□ □		Outdoors	<input type="checkbox"/>
	□□□□ □	□□□□ □		Both	<input type="checkbox"/>
Tue	□□□□ □	□□□□ □	<b><u>Please give further details here</u></b> (please read guidance note 3) □□□□□		
Wed	□□□□ □	□□□□ □	<b><u>State any seasonal variations for the provision of facilities for entertainment of a similar description to that falling within i or j</u></b> (please read guidance note 4) □□□□□		
	□□□□ □	□□□□ □			
Thur	□□□□ □	□□□□ □			
	□□□□ □	□□□□ □			
Fri	□□□□ □	□□□□ □			
	□□□□ □	□□□□ □			
Sat	□□□□ □	□□□□ □			
	□□□□ □	□□□□ □	□□□□□		
Sun	□□□□ □	□□□□ □	□□□□□		
	□□□□ □	□□□□ □			

**L**

Late night refreshment Standard days and timings (please read guidance note 6)			Will the provision of late night refreshment take place indoors or outdoors or both – please tick (please read guidance note 2)	Indoors	<input type="checkbox"/>						
				Outdoors	<input type="checkbox"/>						
Day	Start	Finish	Both <input type="checkbox"/>								
Mon	□□□□ □	□□□□ □	<b>Please give further details here</b> (please read guidance note 3) □□□□□								
	□□□□ □	□□□□ □									
Tue	□□□□ □	□□□□ □									
	□□□□ □	□□□□ □									
Wed	□□□□ □	□□□□ □				<b>State any seasonal variations for the provision of late night refreshment</b> (please read guidance note 4) □□□□□					
	□□□□ □	□□□□ □									
Thur	□□□□ □	□□□□ □									
	□□□□ □	□□□□ □									
Fri	□□□□ □	□□□□ □							<b>Non standard timings. Where you intend to use the premises for the provision of late night refreshment at different times, to those listed in the column on the left, please list</b> (please read guidance note 5) □□□□□		
	□□□□ □	□□□□ □									
Sat	□□□□ □	□□□□ □									
	□□□□ □	□□□□ □									
Sun	□□□□ □	□□□□ □									
	□□□□ □	□□□□ □									

**M**

<b>Supply of alcohol</b> Standard days and timings (please read guidance note 6)			<b>Will the supply of alcohol be for consumption (Please tick box)</b> (please read guidance note 7)	On the premises	<input type="checkbox"/>
				Off the premises	<input checked="" type="checkbox"/>
				Both	<input type="checkbox"/>
Day	Start	Finish	<b>State any seasonal variations for the supply of alcohol</b> (please read guidance note 4)  <b>None</b> <b>Same Licensing hours Everyday</b>		
Mon	<b>06:00</b> □□□□ □	<b>23:00</b> □□□□ □			
Tue	<b>06:00</b> □□□□ □	<b>23:00</b> □□□□ □			
Wed	<b>06:00</b> □□□□ □	<b>23:00</b> □□□□ □			
Thur	<b>06:00</b> □□□□ □	<b>23:00</b> □□□□ □			
Fri	<b>06:00</b> □□□□ □	<b>23:00</b> □□□□ □			
Sat	<b>06:00</b> □□□□ □	<b>23:00</b> □□□□ □			
Sun	<b>06:00</b> □□□□ □	<b>23:00</b> □□□□ □			
			<b>Non standard timings. Where you intend to use the premises for the supply of alcohol at different times to those listed in the column on the left, please list</b> (please read guidance note 5)		

**State the name and details of the individual whom you wish to specify on the licence as designated premises supervisor**

<b>Name</b> Manmeet Singh Grover	
<b>Address</b>  62 Hounslow Road Hanworth Feltham Middlesex	
<b>Postcode</b>	TW13 6QH
<b>Personal Licence number (if known)</b> H03217	



**Issuing licensing authority (if known)**  
**London borough of Hounslow**  
**LB Hounslow SMPP**  
**The Civic Centre, Lampton Road, Hounslow, TW3 4DN**

**N**

**Please highlight any adult entertainment or services, activities, other entertainment or matters ancillary to the use of the premises that may give rise to concern in respect of children (please read guidance note 8)**

O

<b>Hours premises are open to the public</b> Standard days and timings (please read guidance note 6)			<b>State any seasonal variations</b> (please read guidance note 4)  N/A
Day	Start	Finish	<b>Non standard timings. Where you intend the premises to be open to the public at different times from those listed in the column on the left, please list</b> (please read guidance note 5)  N/A
Mon	<b>06:00</b>	<b>23:00</b>	
	<input type="checkbox"/> <input type="checkbox"/> <input type="checkbox"/> <input type="checkbox"/> <input type="checkbox"/>	<input type="checkbox"/> <input type="checkbox"/> <input type="checkbox"/> <input type="checkbox"/> <input type="checkbox"/>	
Tue	<b>06:00</b>	<b>23:00</b>	
	<input type="checkbox"/> <input type="checkbox"/> <input type="checkbox"/> <input type="checkbox"/> <input type="checkbox"/>	<input type="checkbox"/> <input type="checkbox"/> <input type="checkbox"/> <input type="checkbox"/> <input type="checkbox"/>	
Wed	<b>06:00</b>	<b>23:00</b>	
	<input type="checkbox"/> <input type="checkbox"/> <input type="checkbox"/> <input type="checkbox"/> <input type="checkbox"/>	<input type="checkbox"/> <input type="checkbox"/> <input type="checkbox"/> <input type="checkbox"/> <input type="checkbox"/>	
Thur	<b>06:00</b>	<b>23:00</b>	
	<input type="checkbox"/> <input type="checkbox"/> <input type="checkbox"/> <input type="checkbox"/> <input type="checkbox"/>	<input type="checkbox"/> <input type="checkbox"/> <input type="checkbox"/> <input type="checkbox"/> <input type="checkbox"/>	
Fri	<b>06:00</b>	<b>23:00</b>	
	<input type="checkbox"/> <input type="checkbox"/> <input type="checkbox"/> <input type="checkbox"/> <input type="checkbox"/>	<input type="checkbox"/> <input type="checkbox"/> <input type="checkbox"/> <input type="checkbox"/> <input type="checkbox"/>	
Sat	<b>06:00</b>	<b>23:00</b>	
	<input type="checkbox"/> <input type="checkbox"/> <input type="checkbox"/> <input type="checkbox"/> <input type="checkbox"/>	<input type="checkbox"/> <input type="checkbox"/> <input type="checkbox"/> <input type="checkbox"/> <input type="checkbox"/>	
Sun	<b>06:00</b>	<b>23:00</b>	
	<input type="checkbox"/> <input type="checkbox"/> <input type="checkbox"/> <input type="checkbox"/> <input type="checkbox"/>	<input type="checkbox"/> <input type="checkbox"/> <input type="checkbox"/> <input type="checkbox"/> <input type="checkbox"/>	

**P** Describe the steps you intend to take to promote the four licensing objectives:

**a) General – all four licensing objectives (b,c,d,e) (please read guidance note 9)**

Management will control an effective training to all staff that they are aware of the premises licence requirements.

Management will also be made aware of four licensing objectives, Training and key followings

- Underage challenge.
- Drunk and Disorder behavior
- CCTV recording.
- Public Safety

**b) The prevention of crime and disorder**

A Tamper resistant CCTV system will be in place at the premises which is maintained regularly CCTV images are on record for period of 28 days, Recordings of any incidents at the premises to be made secure for inspection by the Police and will be provided on lawful request. This means a member of staff will be available within 24 hours who is capable of operating the CCTV system and providing recordings.

**c) Public safety**

A member of management will be on the premises at all times the store is trading and will be trained to manage the store including looking after the safety of public.

The store will be obliged to all rules and regulations relating to public safety.

Premises will also be taking part in fire safety and health and safety including periodic risk assessments.

Premises will also provide public liability Insurance

**d) The prevention of public nuisance**

Store intends to be an active member of the community. We will be happy to liaise with Police and enforcement authority should the need arise.

Store will also keep an active incident book which will be available to write any incidents by all member of staff.

**e) The protection of children from harm**

All staff will be trained and regularly refreshed with the Think 21 and Challenge 25 policy when selling age restricted products.

New tills will be installed which will operate a 'Challenge 25' policy as a minimum requirement whereby any person appearing to be aged 25 or under must prove that they are in fact over the lawful age of 18 for the purpose of sale of alcohol.

We will also display signage of Challenge 25 and Think 21 policy Signage.

Please tick yes

- I have made or enclosed payment of the fee
- I have enclosed the plan of the premises
- I have sent copies of this application and the plan to responsible authorities and others where applicable
- I have enclosed the consent form completed by the individual I wish to be premises supervisor, if applicable
- I understand that I must now advertise my application
- I understand that if I do not comply with the above requirements my application will be rejected

**IT IS AN OFFENCE, LIABLE ON CONVICTION TO A FINE UP TO LEVEL 5 ON THE STANDARD SCALE, UNDER SECTION 158 OF THE LICENSING ACT 2003 TO MAKE A FALSE STATEMENT IN OR IN CONNECTION WITH THIS APPLICATION**

**Part 4 – Signatures** (please read guidance note 10)

**Signature of applicant or applicant's solicitor or other duly authorised agent** (See guidance note 11). **If signing on behalf of the applicant please state in what capacity.**

Signature	
Date	03 - NOV - 2014
Capacity	DIRECTOR →

**For joint applications signature of 2<sup>nd</sup> applicant or 2<sup>nd</sup> applicant's solicitor or other authorised agent.** (please read guidance note 12). **If signing on behalf of the applicant please state in what capacity.**

Signature	
Date	
Capacity	

<b>Contact name (where not previously given) and postal address for correspondence associated with this application</b> (please read guidance note 13)			
<b>Post town</b>		<b>Post code</b>	
<b>Telephone number (if any)</b>			
<b>If you would prefer us to correspond with you by e-mail your e-mail address (optional)</b>			

## Notes for Guidance

1. Describe the premises. For example the type of premises, its general situation and layout and any other information which could be relevant to the licensing objectives. Where your application includes off-supplies of alcohol and you intend to provide a place for consumption of these off-supplies you must include a description of where the place will be and its proximity to the premises.
2. Where taking place in a building or other structure please tick as appropriate. Indoors may include a tent.
3. For example the type of activity to be authorised, if not already stated, and give relevant further details, for example (but not exclusively) whether or not music will be amplified or unamplified.
4. For example (but not exclusively), where the activity will occur on additional days during the summer months.
5. For example (but not exclusively), where you wish the activity to go on longer on a particular day e.g. Christmas Eve.
6. Please give timings in 24 hour clock (e.g. 16:00) and only give details for the days of the week when you intend the premises to be used for the activity.
7. If you wish people to be able to consume alcohol on the premises please tick on, if you wish people to be able to purchase alcohol to consume away from the premises please tick off. If you wish people to be able to do both please tick both.
8. Please give information about anything intended to occur at the premises or ancillary to the use of the premises which may give rise to concern in respect of children, regardless of whether you intend children to have access to the premises, for example (but not exclusively) nudity or semi-nudity, films for restricted age groups, the presence of gaming machines.
9. Please list here steps you will take to promote all four licensing objectives together.
10. The application form must be signed.
11. An applicant's agent (for example solicitor) may sign the form on their behalf provided that they have actual authority to do so.
12. Where there is more than one applicant, both applicants or their respective agents must sign the application form.
13. This is the address which we shall use to correspond with you about this application.

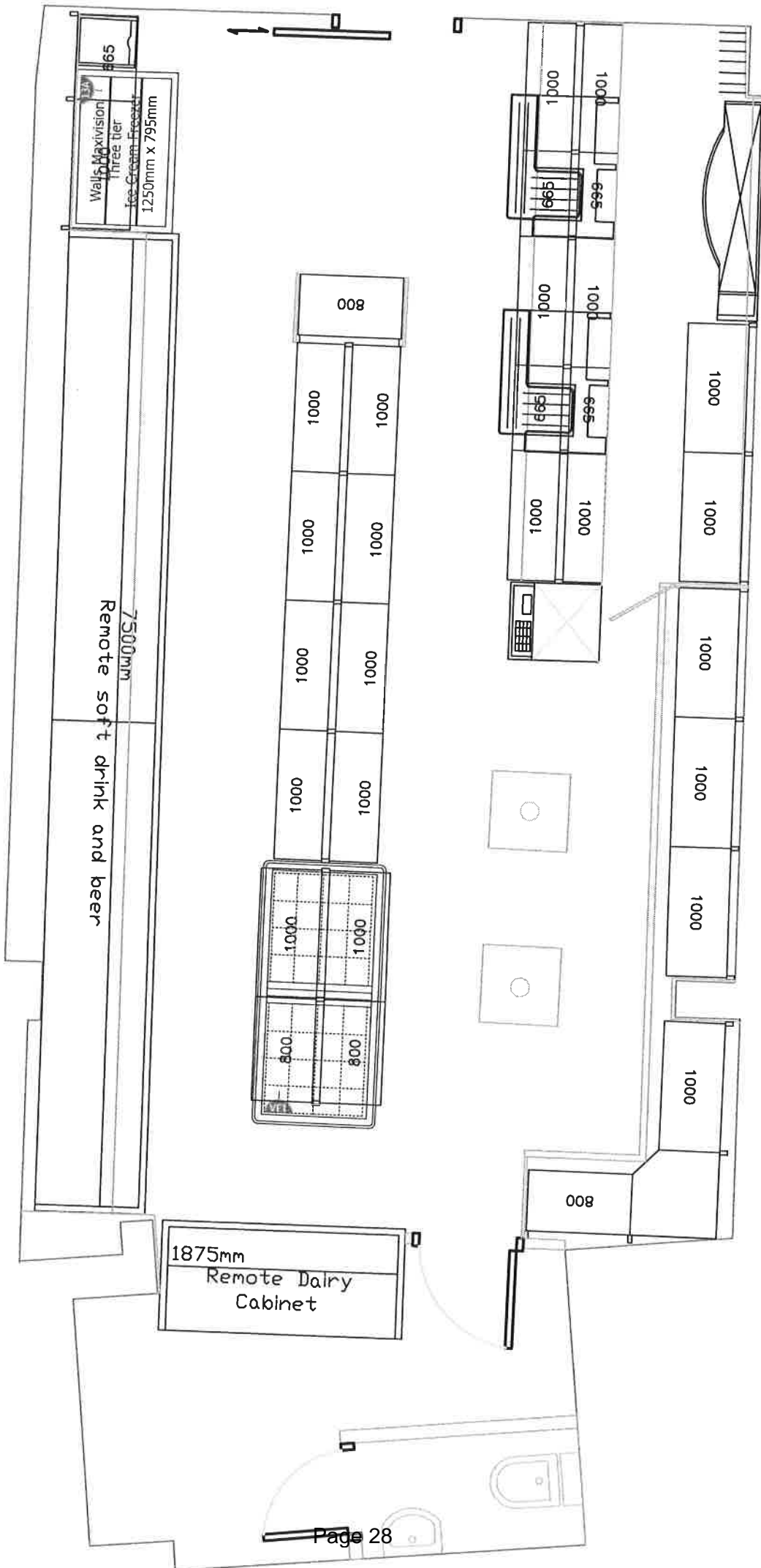

**Paula Barnshaw**

---

**From:** <[redacted]>  
**Sent:** 30 November 2014 12:41  
**To:** licensing  
**Subject:** Objection 126 Frimley Road.public planning notice

Dear Sir

This is my objection representation against the public planning notice in respect of 126 Frimley Road ....(previously Threshers).

I am concerned that with an additional licence premises making it 3 convenience stores selling alcohol in a very short length of the parade approx 150mtrs there will be an increased level of disturbance late in the evening should the licence be approved.

We do not need another convenience store in this area, which is also intended by the application.

It also has been noted recently, that Tescos have submitted an appeal against the refusal of them developing Pembroke house. With this in mind, if they are successful, then it would be 4 in this location encouraging more consumption of alcohol and increasing more footfall/noise etc along this short stretch of premises.

There are far too many alcohol drinking related premises in this location. It will be saturated with these types of facilities.

Of course, then there is the possibility of Krooner Park/Crabtree Park issue of being granted the re-delopment of the Football premise with longer hours, as it will then become a commercial development.

I am concerned of the potential behaviour of consumers able to obtain alcohol at any time every day till late evening and cause trouble by certain groups of the public.

I hope that the new occupiers, if granted, would compromise on their opening hours, by reducing the closing time, with the view of 'calming' down this area of any disturbances.

Thankyou.

**SURREY HEATH BOROUGH COUNCIL**  
**- 1 DEC 2014**  
**COMMUNITY SERVICES - LICENSING**

---

en checked for viruses by Avast antivirus software.

**Paula Barnshaw**

---

**From:** Lee Brewin  
**Sent:** 01 December 2014 08:44  
**To:** Paula Barnshaw; Derek Seekings  
**Subject:** FW: Objections to application for licensed premises - FAO Licensing Department

---

**From:** democratic.services  
**Sent:** 30 November 2014 15:00  
**To:** Jane Sherman; Andrew Crawford; Lee Brewin; Rachel Whillis; Nicola Vooght  
**Subject:** FW: Objections to application for licensed premises - FAO Licensing Department

SURREY HEATH BOROUGH COUNCIL

- 1 DEC 2014

COMMUNITY SERVICES - LICENSING

---

**From:** [redacted]  
**Sent:** 30 November 2014 14:59:54  
**To:** [11701@surrey.pnn.police.uk](mailto:11701@surrey.pnn.police.uk)  
**Cc:** development.control; democratic.services  
**Subject:** Objections to application for licensed premises - FAO Licensing Department  
**Auto forwarded by a Rule**

Dear Sir or Madam,

**Ref:** Licensing Application 126 Frimley Road, Camberley, GU15 2QN

I live in Gordon Avenue, Camberley and was surprised to see the application for another licensed convenience store on the Frimley Road parade of shops. I feel that we are already well served by the existing shops and having another one seems excessive.

However my main concern is that licensing hours that have been applied for would allow people who have drunk heavily in the local area to buy more alcohol which they can then drink in the street as they return home. Limiting the licensing hours for the Grover Convenience Store would lessen this risk. The existing stores do not sell alcohol after 10 pm. Camberley Stores is licensed from 6 am - 11 pm but it actually opens from 7.00 am - 8 pm. Bargain Booze is licensed from 7 am to 10 pm. It would seem sensible that the Grover Convenience Store's licensing hours are in line with these.

Yours sincerely,





**Paula Barnshaw**

---

**From:**  
**Sent:** 01 December 2014 09:58  
**To:** licensing  
**Subject:** FW: Objection to Licensing Application for Grover Convenience Stores, 126 Frimley Road, Camberley, GU15 2QN

Good Morning

For your perusal.

Thank you

Kind Regards  
Carol

**Carol Harrald**  
Technical Support Officer  
Planning, Development and Homes  
Surrey Heath Borough Council  
Surrey Heath House  
Knoll Road  
Camberley  
Surrey  
[www.surreyheath.gov.uk](http://www.surreyheath.gov.uk)

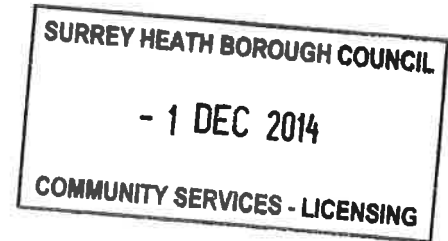

Great Place • Great Community • Great Future

**From:**  
**Sent:** 30 November 2014 16:15  
**To:** Derek Seekings  
**Cc:** development.control  
**Subject:** Objection to Licensing Application for Grover Convenience Stores, 126 Frimley Road, Camberley, GU15 2QN

Dear Sir,

My name is Arun Thapan and I am the owner of Bargain Booze which is at number 120, in the Frimley Road Parade of shops.

I note that an application for a licensed convenience store has been made for 126 Frimley Road by Mr Manmeet Singh Grover. After a meeting with a member of the police and the licensing officer I am satisfied that Mr Grover has taken the necessary precautions to ensure that his shop complies with the regulations.

However, I do have an objection about the extended licensing hours which could attract people who have already drunk too much, particularly later in the evening. If they are able to buy and drink more alcohol they could be a disturbance to those living in the area. My licensing hours are from 7am – 10 pm (but we choose to close at 9:50 pm). Those of Camberley Stores are from 6 am – 11 pm but they close at 8 pm. I would ask that the licensing hours for the Grover Store are limited to 10 pm.

Yours

RECEIVED AT S.H.B.C.  
2014  
POST ROOM

RECEIVED AT S.H.B.C.  
2014  
POST ROOM

MR & MRS. R. CHALK

30. 11. 14.

With Ref. Application of License/Convenience Store  
126, BENTLEY ROAD CARBOROUGH.

TO WHOM IT MAY CONCERN - LICENSING DEPT.

Dear Sir/Madam,

We are writing regarding the application for License/Convenience store. Surely to have two other stores of this type is over the top, causing even more problems with parking within Keover Rd and surrounding areas.

On another point we often see empty beer cans and bottles crushed or broken in the gutters so surely that is another objection to this application.

Surely 3 stores of this type within  
500ms is a No.No

Yours Sincerely

SURREY HEATH BOROUGH COUNCIL

- 1 DEC 2014

COMMUNITY SERVICES - LICENSING

**Paula Barnshaw**

---

**From:**  
**Sent:** 18 November 2014 10:07  
**To:** Paula Barnshaw  
**Subject:** Re: Premises licence application in respect of 126 Frimley Road, Camberley, Surrey GU15 2QN,

Hello Ms Barnshaw,  
My apologies.

✓  
Best wishes.

**From:** Paula Barnshaw  
**Sent:** Tuesday, November 18, 2014 8:57 AM  
**To:** VSM Pharmacy  
**Subject:** RE: Premises licence application in respect of 126 Frimley Road, Camberley, Surrey GU15 2QN,

Dear Sir/Madam,

Please can you supply the name of an individual to ensure that this is a valid representation.

Kind regards,  
**Paula Barnshaw**  
Licensing Administration Officer – Community Services  
Surrey Heath Borough Council  
Surrey Heath House  
Knoll Road  
Camberley  
Surrey  
GU15 3HD  
01276 707322

[www.paula.barnshaw@surreyheath.gov.uk](mailto:paula.barnshaw@surreyheath.gov.uk)

If your email contains either a Freedom of Information or an Environmental Information Request, please forward it to [foi@surreyheath.gov.uk](mailto:foi@surreyheath.gov.uk). If you do not forward it on, the time for answering your request will have paused until I return to the office.

Great Place • Great Community • Great Future  
[www.surreyheath.gov.uk](http://www.surreyheath.gov.uk)

---

**From:** \  
**Sent:** 17 November 2014 18:36  
**To:** licensing  
**Subject:** Premises licence application in respect of 126 Frimley Road, Camberley, Surrey GU15 2QN,

The Licensing Officer,  
Surrey Heath Borough Council,  
Knoll Road,  
Camberley.

17 November 2014.

Dear Sir/Madam,

With regards to the Premises licence application in respect of 126 Frimley Road, Camberley, Surrey GU15 2QN, we wish to object to the granting of liquor license for the following reasons.

1. The prevention of crime and disorder : Though the premises will be guarded by CCTV, we fear the alcohol will be drunk in the poorly lit side road – Krooner Road. This will cause serious litter problem and possible vandalism of our premises. It is conceivable that youth may congregate on the corner of the premises and cause public disorder.
2. Public Safety : The Government's agenda for better public health with excessive alcohol consumption as one of the main concerns, it does not seem reasonable or in keeping with public health programme of reducing alcohol consumption that yet another outlet to offer more alcohol to public is safe.
3. Prevention public nuisance : There can be no doubt that inebriated individuals will cause public nuisance without any consideration to the residents of this area.
4. Protection of children from harm : Krooner Road is small residential road and majority of the houses are occupied by families with children. The sight of drunken individual whilst the children are playing is harmful to safety of children and could encourage the children to think that this is a normal behaviour.

All the assurances by the applicant are really effective within their premises and there is clearly no assurance that neighbourhood will be afforded any protection in respect of the four required criteria. Though not of prime consideration, there are already sufficient outlets selling alcohol on off license and on license basis.

More of the same is not the way to revive secondary high streets. Consideration should be given to varied trades offering choice to the local community and avoiding the need for them to travel miles to obtain day to day living needs.

Yours faithfully,



VSM Pharmacy, 124 Frimley Road, Camberley. Surrey GU15 2QN  
Phone:01276.21002

**Confidentiality Notice:** All the information contained in this e-mail is privileged, confidential, for the intended recipient(s) alone and exempt from disclosure under English law. If you are not an intended recipient, you must not copy, distribute or take any action in reliance on it. If you have received this e-mail in error, please accept our apology and notify us immediately either by using the reply facility on your e-mail system or by phone on +44 (0)1276 21002 and permanently delete this mail.

## Derek Seekings

---

**From:** nimisha patel [REDACTED]  
**Sent:** 01 December 2014 16:26  
**To:** Derek Seekings  
**Subject:** RE: Premises Licence Application

Nimisha Patel  
[REDACTED] Frimley Road  
CAMBERLEY  
Surrey  
GU15 2QN

Dear sir/madam

I am the occupier of the above address property and I wish to object strongly along with the other resident not to have an off-license at the address of 126 Frimley Road. As we already have 3 outlets which are currently trading off-licenses. We also have schools nearby and it could increase underage crime rates and them drinking alcohol.

This property was an off-license previously and has been closed down for a long period of time. In my opinion it should not be granted as an off-license. We want less crime, good environment and better education in this area.

Thank you for your consideration and we hope you consider this objection strongly

Yours sincerely  
Nimisha Patel

This page is intentionally left blank